

Tandberg Edge Installation



Step 1

Step 2

1. Plug the black RCA connector on one end of **Cable C** into Tandberg video-station <Audio Out 1>, and then plug the black RCA connector on the other end into the Fusion Base Station <Conf In>. The other RCA connector is not used.
2. Plug one XLR connector of **Cable D**, XLR to XLR, into Tandberg video-station <Mic 1 Input> and the other XLR connector into the Fusion Base Station Mic Level Output <XLR>.

To configure the Tandberg system:

Select the button from the main screen to access the System menu.

Go to **Audio** settings

Confirm or modify the following settings:

- **Input 1 - MIC**
- **Output 1 - ON**
- **Audio Leveling - OFF**
- **Echo Canceller and Noise Reduction (EC and NR) - OFF**

Adjust the audio **Input Level** if necessary.

Speak into the Revolabs microphones that are connected to the audio line inputs.

The audio meter should peak at about 5 dB.

Tandberg Set Top MXP Installation

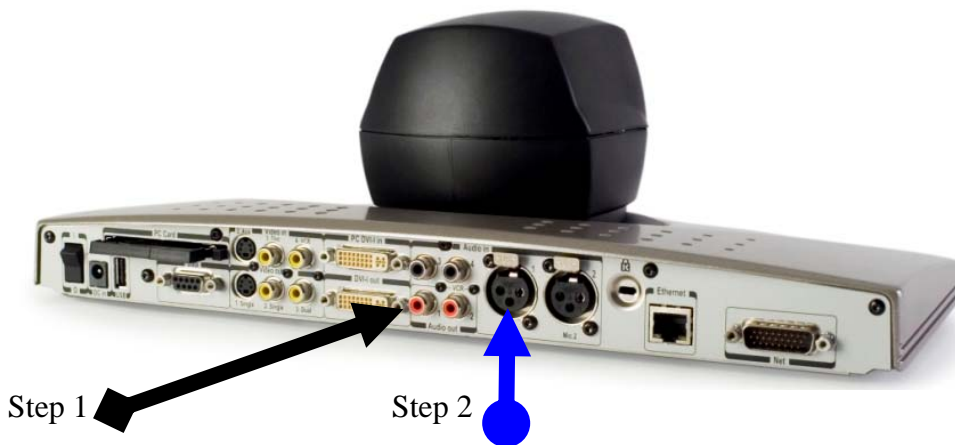

Step 1

Step 2

1. Plug the black RCA connector on one end of **Cable C** into Tandberg video-station <Audio Out 1>, and then plug the black RCA connector on the other end into the Fusion Base Station <Conf In>. The other RCA connector is not used.

2. Plug one XLR connector of **Cable D**, XLR to XLR, into Tandberg video-station <Mic 1 Input> and the other XLR connector into the Fusion Base Station Mic Level Output <XLR>.

To configure the Tandberg system:

Select the button from the main screen to access the System menu.

Go to **Audio** settings

Confirm or modify the following settings:

- **Input 1 - MIC**
- **Output 1 - ON**
- **Audio Leveling - OFF**
- **Echo Canceller and Noise Reduction (EC and NR) - OFF**

Adjust the audio **Input Level** if necessary.

Speak into the Revolabs microphones that are connected to the audio line inputs.

The audio meter should peak at about 5 dB.

Tandberg Profile MXP Installation

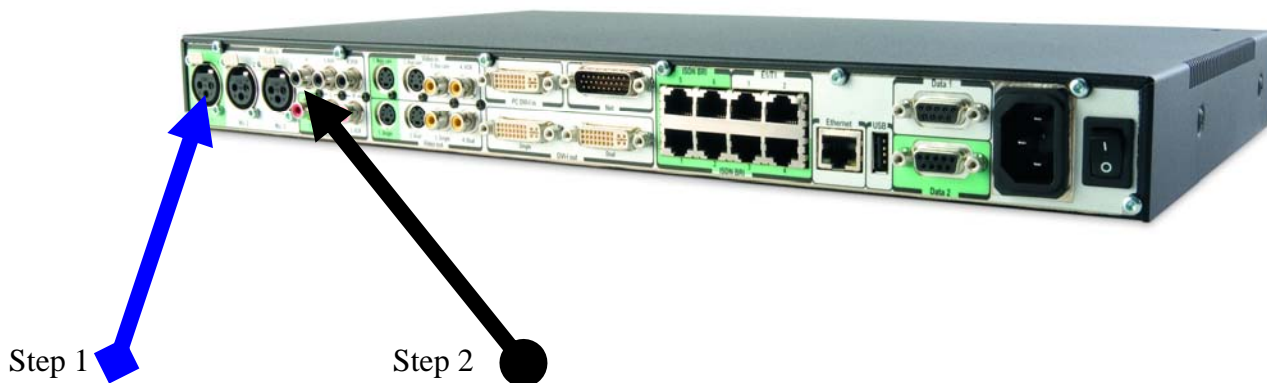

1. Plug one XLR connector of **Cable D**, XLR to XLR, into Tandberg video-station <Mic 1 Input> and the other XLR connector into the Fusion Base Station Mic Level Output <XLR>.
2. Plug the black RCA connector on one end of **Cable C** into Tandberg video-station <Audio Out 1>, and then plug the black RCA connector on the other end into the Fusion Base Station <Conf In>. The other RCA connector is not used.

To configure the Tandberg system:

Select the button from the main screen to access the System menu.

Go to **Audio** settings

Confirm or modify the following settings:

- **Input 1 - MIC**
- **Output 1 - ON**
- **Audio Leveling - OFF**
- **Echo Canceller and Noise Reduction (EC and NR) - OFF**

Adjust the audio **Input Level** if necessary.

Speak into the Revolabs microphones that are connected to the audio line inputs.

The audio meter should peak at about 5 dB.